

# NOT FOR NEW INSTALLATION

## INSTALLATION AND SERVICE MANUAL

**LIGMAN**  
NORTH AMERICA

For Installation of LED Module Assembly - ULE-40611 - (Legend Recessed - 48 LED)

### Product drawing (dimensions)

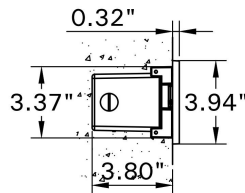
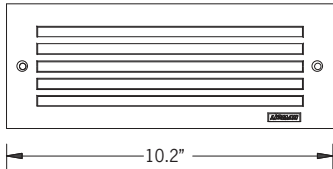

### SUITABLE FOR WET LOCATIONS

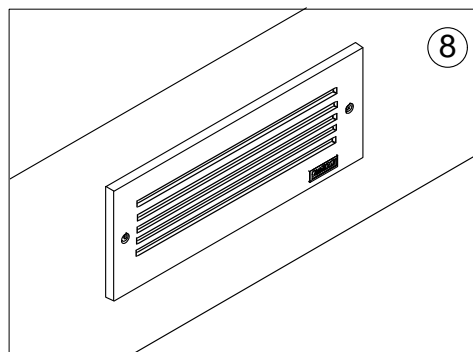
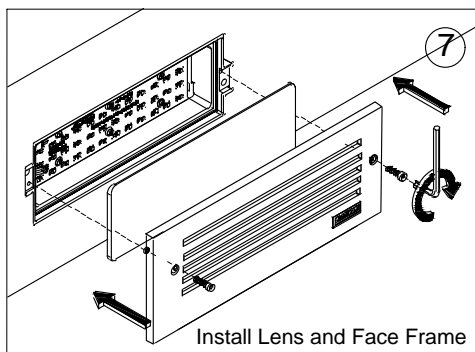
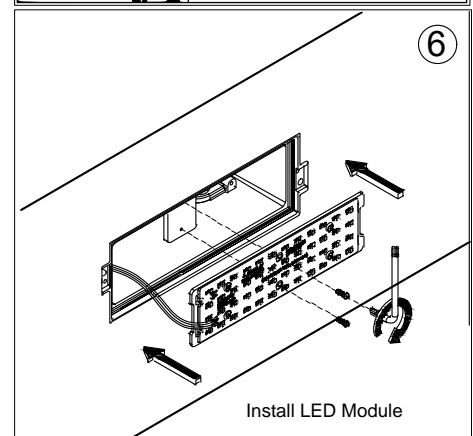
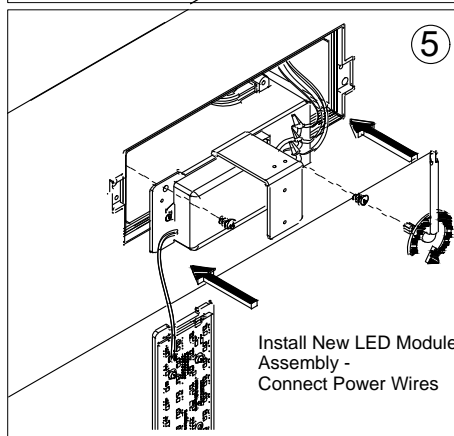
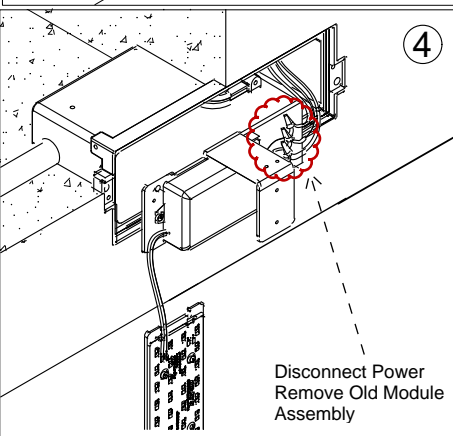
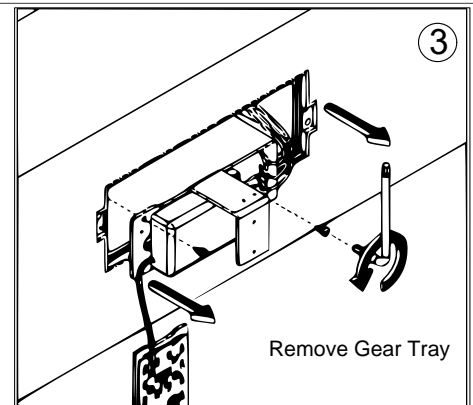
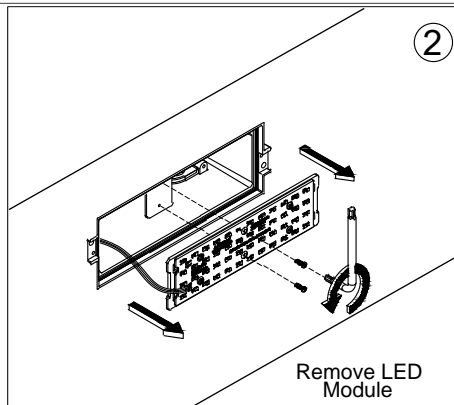
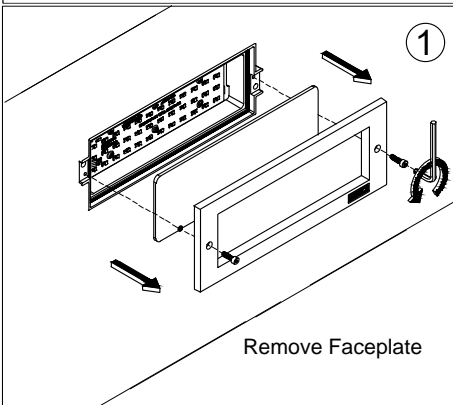
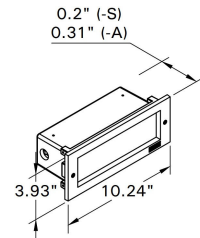

### Notice to Installer

#### Wiring Instruction ⚠ Warning:

- Risk of Fire and Electrical Shock, This fixture must be installed only by a qualified electrician, Installation must adhere to the National Electrical Code (NEC) and all applicable local and federal regulations.
- Always disconnect power before servicing the fixture.

**Ligman Lighting USA**

7144 NE Progress Court, Hillsboro  
Oregon, 97124, USA  
Tel : 503 645 0500